

EFFICIENT ■ INNOVATIVE ■ RELIABLE

**KEERTHI**   
PUMPS

# Augmented **PERFORMANCE**

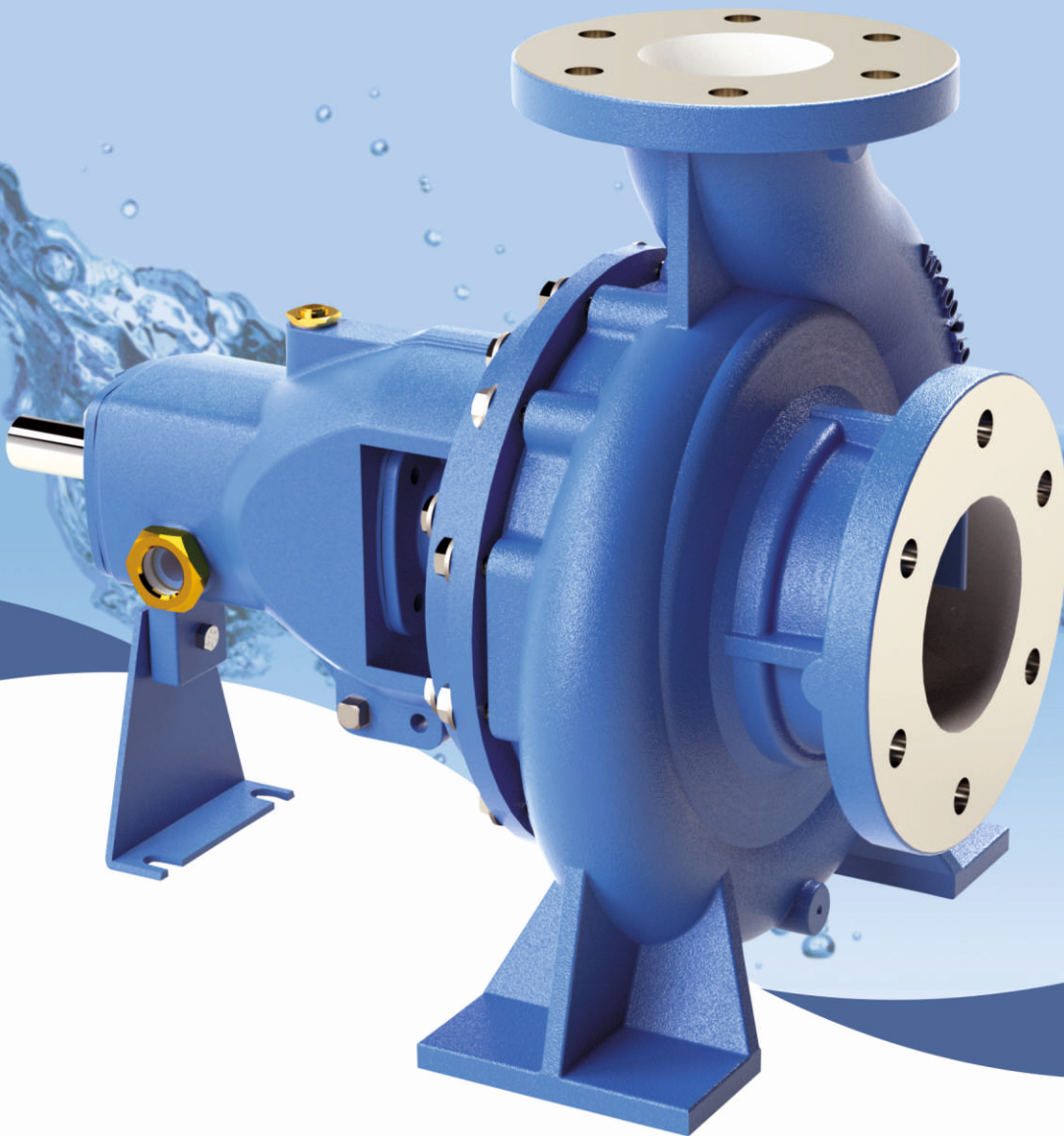

## Horizontal Single Stage Centrifugal **END SUCTION PUMP** **WPX SERIES**

According to DIN 24255 / EN 733

# Horizontal Single Stage Centrifugal END SUCTION PUMP WPX SERIES

According to DIN 24255 / EN 733

KEERTHI Pumps is renowned for manufacturing the highest quality pumping equipment utilizing the best engineering practices available worldwide. The single stage end suction pump has been designed with latest CAD (Computer Aided Design) and CFD (Computational Fluid Dynamics) and is in Accordance with the DIN 24255 / EN 733. Flange Dimension as per DIN 2533 / ANSI B 16.5: 2009.

These Pumps are frame mounted end-suction pumps which are used for heavy duty applications. A general-purpose centrifugal pump with heavy wall castings, a choice of different material combinations makes the pump suitable for every need in commercial, industrial water transportation water supply, municipal applications, irrigation, heating, ventilation, air conditioning, firefighting process secondary pumping, raw water intake and irrigation systems. It also make it suitable for handling of water in various process industries like paper, sugar food & textile.

A wide range KEERTHI's pumps is available which can be modified for specific duties by trimming the impeller diameter that can be done with reference to the particular pump curve. Motors should be selected according to the pump speed and impeller diameter and thus mount together with the pumps on a base frame with coupling. The pumps are also suitable for belt drive by either electric motor or a diesel engine.

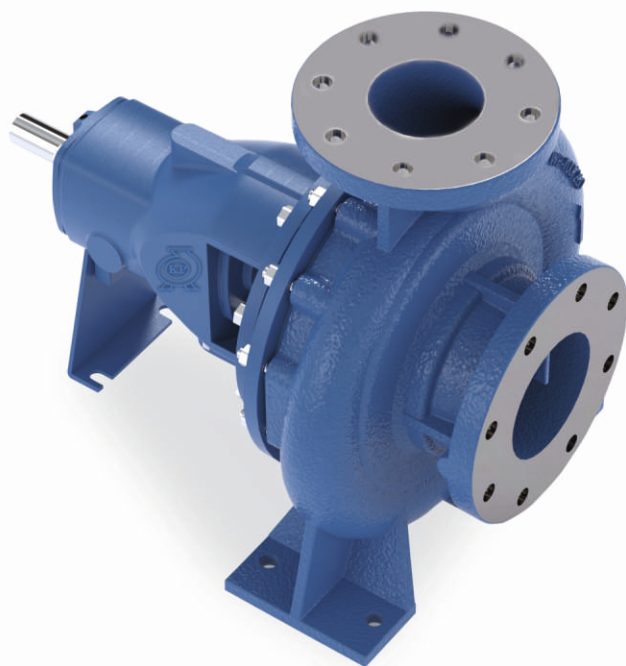

## TECHNICAL SPECIFICATION

MODEL	WPX SERIES
Head Range upto m/ft	100 / 328
Flow rate upto m³/h	550
Max. Casing Working Pre. bar	16
Casing Test Pressure bar	20
Impeller Diameter mm	130 to 330
Suction Diameter	DN 50 - DN 200
Discharge Diameter	DN 32 - DN 150
Speed Range rpm	1450 - 2900
Max. Working Temperature	-10°C upto +100°C
Discharge Flanges	DN 32-150 DIN 2533-PN 16
Suction Flanges	DN 50-200 DIN 2533-PN 16

**Pumped Liquids :** Thin, clean, non-aggressive and non-explosive liquids free from large solid particles or fibers. Designed for non-combustible, low viscosity liquids, free of solids, abrasive materials and fibers.

## APPLICATION



**BUILDING**

- ✦ HVAC
- ✦ Hot water circulation
- ✦ Water supply and booster stations
- ✦ Water circulating for swimming pools
- ✦ Sanitary and cleaning installations



**WATER  
SUPPLY**

- ✦ Municipalities
- ✦ Industrial applications and public services
- ✦ Agriculture Irrigations
- ✦ Fire Fighting



**GENERAL  
INDUSTRY**

- ✦ Food Industries
- ✦ Pulp and Paper Industry
- ✦ Fresh water - Marine industry
- ✦ White water (below pulp conc. of 0.3%)
- ✦ Automotive Industry, Detergent (without slurry)
- ✦ Pumping of condensate, Power plants
- ✦ Steel Industry, Non-ferrous metals Industry
- ✦ Greenhouse, Desalination, Aquaculture

## MODEL IDENTIFICATION CODE

**WPX 80/200 MXX - GP/MS - GL**

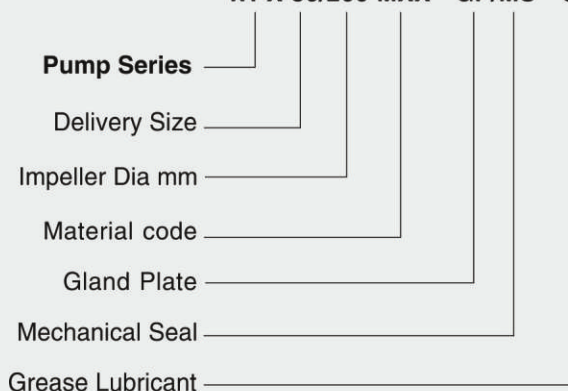



## CONSTRUCTIONAL FEATURES

These are single stage, single suction, and horizontal shaft type. They are made in accordance with DIN 24255 / EN 733 with heavy duty bearings. Models are available to operate at 1450 rpm and 2900 rpm at 50 Hz and 1750 rpm and 3500 rpm at 60 Hz.

**Construction Material :** The WPX series comes with cast iron casing wet end, SS 304/ CI / BRONZE impeller, wear rings and EN8 shaft as standard. In order to suit a wider range of applications.

**Design Versions :** The pump comes in two designs: "WPX" frame mount series is suitable for long coupled is suitable for direct attachment to 2, 4 & 6 pole IEC frame motors. The standard horizontal configuration units have a vertical centerline discharge; however, these models can also be mounted in a variety of different positions including horizontal discharge of the pump bearing housing.

A wide range of 37 Models & superior hydraulics allows more water to flow with maximum efficiency. All this is possible with just 4 varieties of bearing brackets, which gives you an added advantage of maximum interchangeability. Simplified service and a low number of spare parts. This means that low maintenance costs can be obtained.

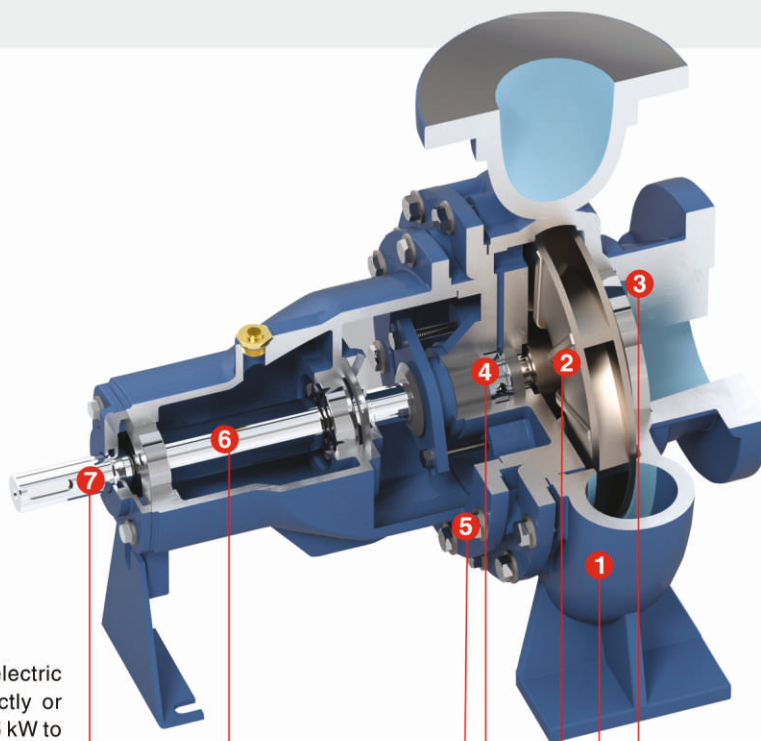

**Drive :** Suitable for coupling with electric motors, Bare shaft - engines directly or through belt drive. Motors from 0,75 kW to 750kW are guaranteed in IE3 efficiency class / FLP. Direction of Rotation : Clockwise viewed from driving end.

**Shaft & Shaft Sleeve :** Enlarged the shaft are sturdy, with a deflection of less than less than 0.05mm at the Seal areas under Normal running conditions with tapered shaft keyed design ensuring positive locking when in operation and ease of impeller removal whilst servicing. All shafts are protected by a replaceable sleeve in stainless steel or higher quality alloys. The high tensile steel shaft accurately machined, and ground is supported by antifriction bearings. The shaft is protected by shaft sleeve from wear in stuffing box area.

**Stuffing Box :** The stuffing box can be sealed by gland packing or by mechanical seal.

**Shaft Seals :** The alternatives include single and double mechanical seals, gland packing and dynamic seals, with a variety of material to suit every application. The standard Mechanical seal consists of carbon rotating face and ceramic stationary face with Viton® fluor elastomers. Pumps are supplied as standard a conventional packet gland, lantern ring for water sealing and Lubricating of packing.

**Wearing Ring :** The wearing Ring is replaceable and can be easily adjusted from the pump casing's front. This makes it easy to maintain high efficiency over the entire lifetime of the pump and ensures shorter MTTR (Mean Time to Repair).

**Pump Casing :** Rugged pump construction creates long-term, wear resistance. The generous wall thickness and the casing's smooth, pocket-free interior protect against erosion and corrosion. End suction, volute type with top centerline discharge. Suction and discharge nozzles as well as the supporting feet are cast integral with the casing.

**Impeller :** Enclosed type and accurately balanced dynamically. Hydraulically balanced by back vanes and for large impellers by balancing holes and back wear rings. The sturdy construction ensures high wear resistance, resists corrosion and reduces sensitivity to foreign objects.

**Optional :** Drilling as per IS/BS/ASA/DIN available with suitable pressure rating.

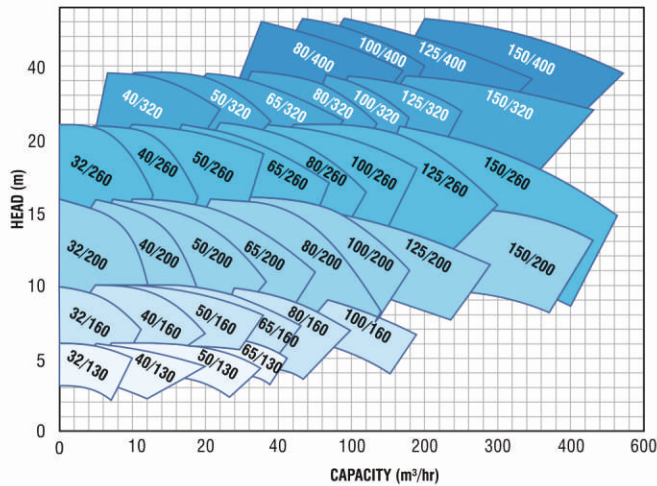
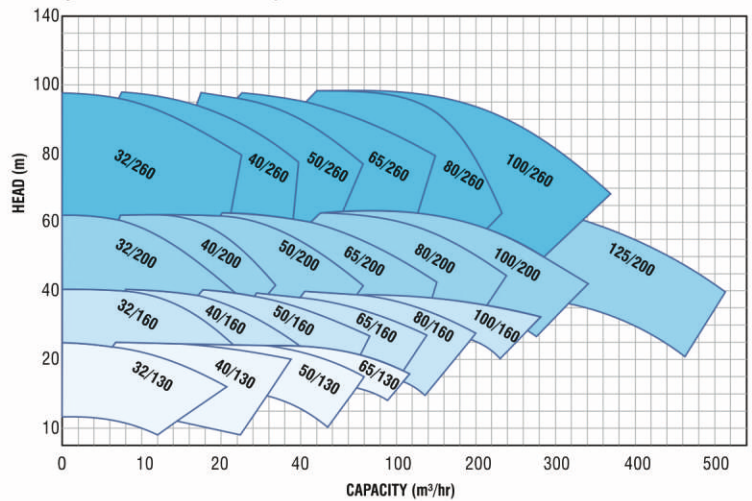
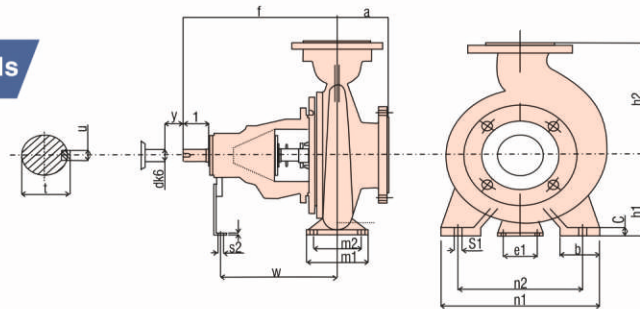

**Family Curve - 1450 rpm @ 50Hz**

**Family Curve - 2900 rpm @ 50Hz**

**General Dimension / Mounting Details**

All dimensions are in mm

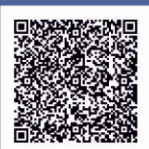
PUMP SIZE	PUMP DIMENSION						FOOT DIMENSION										SHAFT END			DISTANCE	
	NWD	NWS	a	f	h1	h2	b	c	m1	m2	n1	n2	s1	e1	s2	w	dk6	l	t	u	y
32/130	32	50	80	360	112	140	50	14	100	70	190	140	14	100	14	267	24	50	27	8	140
32/160	32	50	80	360	132	160	50	14	100	70	240	190	14	100	14	267	24	50	27	8	140
32/200	32	50	80	360	160	180	50	14	100	70	240	190	14	110	14	267	24	50	27	8	140
32/260	32	50	100	360	180	225	65	14	125	95	320	250	14	110	14	267	24	50	27	8	140
40/130	40	65	80	360	112	140	50	14	100	70	210	160	14	100	14	267	24	50	27	8	140
40/160	40	65	80	360	132	160	50	14	100	70	240	190	14	100	14	267	24	50	27	8	140
40/200	40	65	100	360	160	180	50	14	100	70	265	212	14	110	14	267	24	50	27	8	140
40/260	40	65	100	360	180	225	65	14	125	95	320	250	14	110	14	267	24	50	27	8	140
40/320	40	65	125	470	200	250	65	14	125	95	345	280	14	110	14	342	32	80	35	10	140
50/130	50	65	100	360	132	160	50	14	100	70	240	190	14	110	14	267	24	50	27	8	140
50/160	50	65	100	360	160	180	50	14	100	70	265	212	14	110	14	267	24	50	27	8	140
50/200	50	65	100	360	160	200	50	14	100	70	265	212	14	110	14	267	24	50	27	8	140
50/260	50	65	100	360	180	225	65	14	125	95	320	250	14	110	14	267	24	50	27	8	140
50/320	50	80	125	470	225	280	65	14	125	95	345	280	14	110	14	342	32	80	35	10	140
65/130	65	80	100	360	160	180	65	14	125	95	280	212	14	110	14	267	24	50	27	8	140
65/160	65	80	100	360	160	200	65	14	125	95	280	212	14	110	14	267	24	50	27	8	140
65/200	65	80	100	360	180	225	65	14	125	95	320	250	14	110	14	267	24	50	27	8	140
65/260	65	100	100	470	200	250	80	16	160	120	360	280	18	110	14	342	32	80	35	10	140
65/320	65	80	125	470	225	280	80	16	160	120	400	315	18	110	14	342	32	80	35	10	140
80/160	80	100	125	360	180	225	65	14	125	95	320	250	14	110	14	267	24	50	27	8	140
80/200	80	100	125	470	180	250	65	14	125	95	345	280	14	110	14	342	32	80	35	10	140
80/260	80	100	125	470	200	280	80	16	160	120	400	315	18	110	14	342	32	80	35	10	140
80/320	80	100	125	470	250	315	80	16	160	120	400	315	18	110	14	342	32	80	35	10	140
80/400	80	125	140	530	280	355	80	18	160	120	435	355	18	110	14	370	42	110	45	12	140
100/200	100	125	125	470	200	280	80	16	160	120	360	280	18	110	14	342	32	80	35	10	140
100/260	100	125	140	470	225	280	80	16	160	120	400	315	18	110	14	342	32	80	35	10	140
100/320	100	125	140	470	250	315	80	16	160	120	400	315	18	110	14	342	32	80	35	10	140
100/400	100	125	140	530	280	355	100	18	200	150	500	400	23	110	14	370	42	110	45	12	140
125/260	125	150	140	470	250	355	80	16	160	120	400	315	18	110	14	342	32	80	35	10	140
125/320	125	150	140	530	280	355	100	18	200	150	500	400	23	110	14	370	42	110	45	12	140
125/400	125	150	140	530	315	400	100	18	200	150	500	400	23	110	14	370	42	110	45	12	140
150/260	150	200	160	530	280	400	100	18	200	150	500	400	23	110	14	370	42	110	45	12	140
150/320	150	200	160	530	280	400	100	18	200	150	550	450	23	110	14	370	42	110	45	12	140
150/400	150	200	160	530	315	450	100	18	200	150	550	450	23	110	14	370	42	110	45	12	140

In view of continuous developments the information in the catalogue are subject to change without prior notice.

**Keerthi Pumps India Private Limited**

Manufacturing &amp; Marketing Division

 1/514, Anna Nagar, Neelambur (PO),  
Coimbatore - 641 062. Tamil Nadu, INDIA

Follow us :

**Get In Touch**

+91 75400 82622, 23

sales@keerthipumps.com

marketing@keerthipumps.com

www.keerthipumps.com